

Property
Knowledge

NH Collection
Eindhoven Cente



NH COLLECTION
HOTELS

Unique Selling Points



NH COLLECTION
HOTELS

Unique Selling Points

- NH Collection Eindhoven Centre is the only 5-star (superior) hotel in Eindhoven and the South of the Netherlands.
 - Highest Service level
- Located in the city centre of Eindhoven, just 2 minutes away from the central station of Eindhoven
 - Roof top cocktail bar with terrace - VANE Skybar
 - Fine dining restaurant – VANE Restaurant

Location and General Information



NH COLLECTION
HOTELS

Location

The 5-star **NH Collection Eindhoven Centre** is exceptionally located in the heart of the city, making it an ideal base for business and leisure travelers. With the train station, museums and some of the city's finest stores nearby, the hotel itself is housed in a contemporary local landmark the Groene Toren, or Green Tower. Its exterior metropolitan look continues inside where the highest level of comfort is complemented by luxurious furnishings. Opened in 2017, its recently awarded fifth star is proof of the highest standards in service offered throughout.

- 2 minutes walk from Eindhoven Central Station
- 15 minutes drive from Eindhoven Airport
- Close to all the sights within Eindhoven: Philips Museum, van Abbe Museum, shopping streets and centre, casino's and music venues.
- 10 minutes walking distance from PSV football stadium

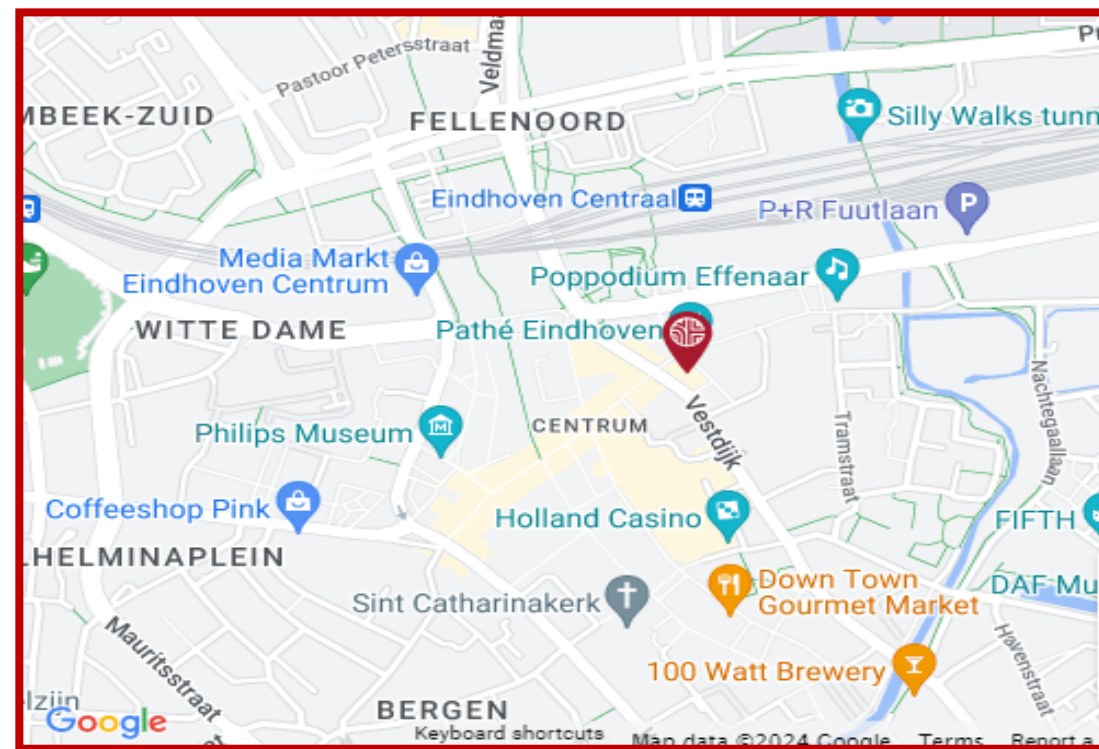

General Information

Our 14-floor hotel has 132 generously sized rooms, all freshly decorated in modern style.

- Bluetooth media player, satellite TV and high-speed Wi-Fi in every room
- larger rooms available for families with double beds and baby cribs
- French balconies in all rooms

Guests can enjoy a meal in the hotel restaurant, or relax in the rooftop bar with terrace which offers panoramic views over the city.

- compact, complimentary gym on the first floor
- top floor restaurant with a view over Eindhoven
- 6 meeting rooms with a maximum total capacity of 160 – ideal for business and social events

Parking

Off Site parking recommendation:

Qpark de Heuvel - Ten Hagestraat 6A, Eindhoven

3,10 euro per hour – 25,00 euro per 24 hours.

Parking can not be paid at the hotel's reception, nor are we able to offer a discounted rate

Bus Parking

Parking spot for busses in front of the hotel. Only for short parking to let guests get on and off of the bus.

Long term bus parking: <https://lokaleregelgeving.overheid.nl/CVDR657478>

Meeting Rooms



NH COLLECTION
HOTELS

Meeting Rooms – General Information

NH Collection Eindhoven Centre has six meeting rooms, which can be set-up in all different kind of settings, with a maximum capacity up to 160 guests. The rooms are available for rent for any occasion between a few hours to an entire day. All the business essentials are provided, including sound equipment and projectors.





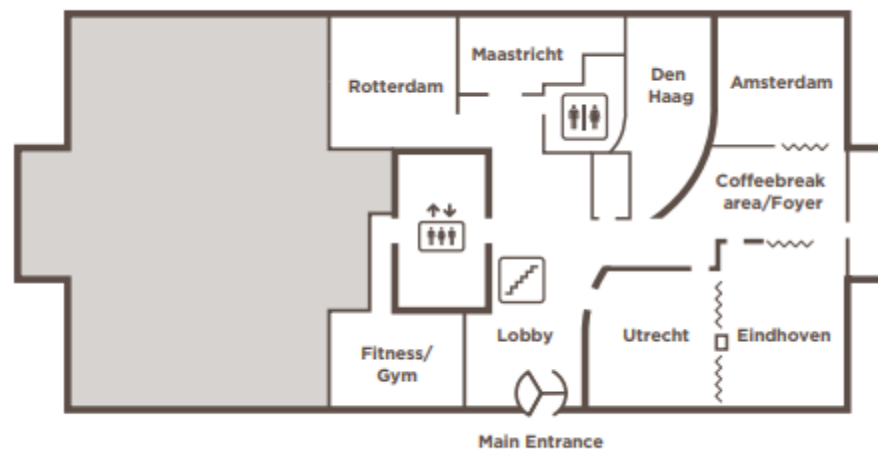

SPECIAL FEATURES

- All meeting rooms have floor to ceiling windows, offering an abundance of daylight
- High-speed internet connection
- Wireless presentation system
- All meeting rooms are located on the first floor, which is a great asset for clients who wish to have exclusivity during their meetings,

FIRST FLOOR



Meeting Rooms - Capacities

MEETING ROOM NAME	AREA		 square	 u-shape	 theatre	 cabaret	 classroom	 cocktail	 dinner	DAYLIGHT
	M ²	FEET								
Utrecht	53	570	18	15	40	28	27	40	40	YES
Maastricht	43	344	18	15	32	21	18	32	30	YES
Eindhoven	70	753	18	24	50	42	36	50	50	YES
Amsterdam	54	581	18	18	45	28	27	45	40	YES
Den Haag	45	484	18	21	35	21	24	35	30	YES
Rotterdam	61	656	18	24	45	28	36	45	40	YES
Utrecht/Eindhoven	123	1323	-	-	-	-	-	90	90	YES
Eindhoven/Amsterdam	169	1819	-	-	-	-	-	120	110	YES
Utrecht/Eindhoven/Amsterdam	222	2389	-	-	-	-	-	160	150	YES

*Meeting room 'Den Haag' is currently used as a storage. Please check with the hotel first whether we can offer this room when it's needed for a request



OUR MEETING PACKAGES AT A GLANCE

NH MEETINGS
inspire. create. enjoy.

NH COLLECTION EINDHOVEN CENTRE MEETING PACKAGES	EXCELLENT <small>EXCELLENCE</small>	PREMIUM <small>PREMIUM</small>	COMFORT <small>COMFORT</small>	SMART <small>SMART</small>	LIGHT <small>LIGHT</small>
Meeting room rental with free Wi-Fi	✓	✓	✓	✓	✓
Projector, flipchart, presentation case	✓	✓	✓	✓	✓
Lunch** - Unlimited buffet	✓	✓	✓	✓	✓
Tempting Breaks - Selection of sweet, savoury, locale and themed bites (8h: 2x, 4h: 1x)	✓✓	✓✓	✓	✓	✓
Welcome coffee & tea - Served upon arrival	✓	✓	✓	✓	
Coffee & tea in the lounge - Unlimited	✓	✓	✓	✓	
Fresh fruit in the meeting room	✓	✓	✓	✓	
Drinks in the meeting room - Incl. soft drinks, mineral water	✓	✓	✓	✓	
Drinks during lunch - Incl. soft drinks, mineral water	✓	✓	✓	✓	
Warm welcome buffet - With sweet delicacies	✓	✓	✓		
Fresh juices in the meeting room - Incl. fruit juices & smoothies	✓	✓	✓		
Closing drink - NH water bottle to go	✓	✓	✓		
Closing package*** - Closing bites and drinks	✓✓	✓✓	✓		
Snack in the meeting room - Sweet and savoury snacks	✓	✓	RECOMMENDED		
Dinner package - Dinner buffet incl. drinks	✓				

PREMIUM ✓✓
 PACKAGES:
 FULL DAY - 8h
 HALF DAY - 4h incl. lunch
 HALF DAY - 4h excl. lunch

*Meeting package 'Excellent' can only be offered on Sundays, Mondays or Tuesdays. This due to the buffet dinner which we only offer on closing days in VANE Restaurant

Meeting Rooms - Maastricht



Specifications: With it's 43 m2, this is our smallest meeting room, ideal for small board meeting or as break out room,

AV: Beamer and screen, build in. Can be connected via VGA/HMDI cables which are available in the room

Connectable with other meeting rooms: No

Most used set Ups:

- U-Shape | 15
- Boardroom | 17
- Classroom | 18
- Theater | 25

Meeting Rooms - Rotterdam



Specifications: 61 m2 - Located at the back of the building, makes this room a quite and convenient space.

AV: Beamer and screen, build in. Can be connected via VGA/HMDI cables which are available in the room

Connectable with other meeting rooms: No

Most used set Ups:

- U-Shape | 25
- Boardroom | 25
- Classroom | 36
- Theater | 45

Meeting Rooms - Eindhoven



Specifications: 70 m2 – Our largest and most used meeting room.

AV: Beamer and screen, build in. Can be connected via VGA/HMDI cables which are available in the room

Connectable with other meeting rooms: Yes – Utrecht and/or Amsterdam can be connected with this room. If all 3 are connected, the foyer (coffee break area) will also be included in this space. (important to know if also the Rotterdam and/or Maastricht are in use)

Most used set Ups:

- U-Shape | 25
- Boardroom | 25
- Classroom | 36
- Theater | 50

Meeting Rooms - Amsterdam



Specifications: 70 m2 – Our largest and most used meeting room.

AV: Beamer and screen, build in. Can be connected via VGA/HMDI cables which are available in the room

Connectable with other meeting rooms: Yes – Utrecht and/or Amsterdam can be connected with this room. If all 3 are connected, the foyer(coffee break area will also be included in this space. (important to know if also the Rotterdam and/or Maastricht are in use)

Most used set Ups:

- U-Shape | 25
- Boardroom | 25
- Classroom | 36
- Theater | 50

Meeting Rooms - Utrecht



Specifications: 70 m2 – Our largest and most used meeting room.

AV: Beamer and screen, build in. Can be connected via VGA/HMDI cables which are available in the room

Connectable with other meeting rooms: Yes – Utrecht and/or Amsterdam can be connected with this room. If all 3 are connected, the foyer(coffee break area will also be included in this space. (important to know if also the Rotterdam and/or Maastricht are in use)

Most used set Ups:

- U-Shape | 25
- Boardroom | 25
- Classroom | 36
- Theater | 50

Meeting Rooms – Additional Information

- Coffee breaks are served in our coffee break area.
 - Lunch is served in VANE Restaurant on the 13th floor. Buffet lunch for groups larger than 15 pax. Otherwise plated lunch,
 - Some rooms can be connected due to the flexible walls.
- When selling this, there are a few important points to keep in mind:

Eindhoven - Amsterdam – Utrecht

When Rotterdam and/or Maastricht are also in use, breaks need to be served in the meeting rooms for them.

Amsterdam – Eindhoven

When Rotterdam and/or Maastricht are also in use, breaks need to be served in the meeting rooms for them.

Utrecht can not be sold separately in this scenario.

due to the walls which are open.

Eindhoven – Utrecht

There are concrete pillars marked as grey blocks, this is

important to keep in mind with the set up.

Emergency Exit

- No chairs or tables can be placed here
- AV Partner: Bazelmans. Info@Bazelmans.com

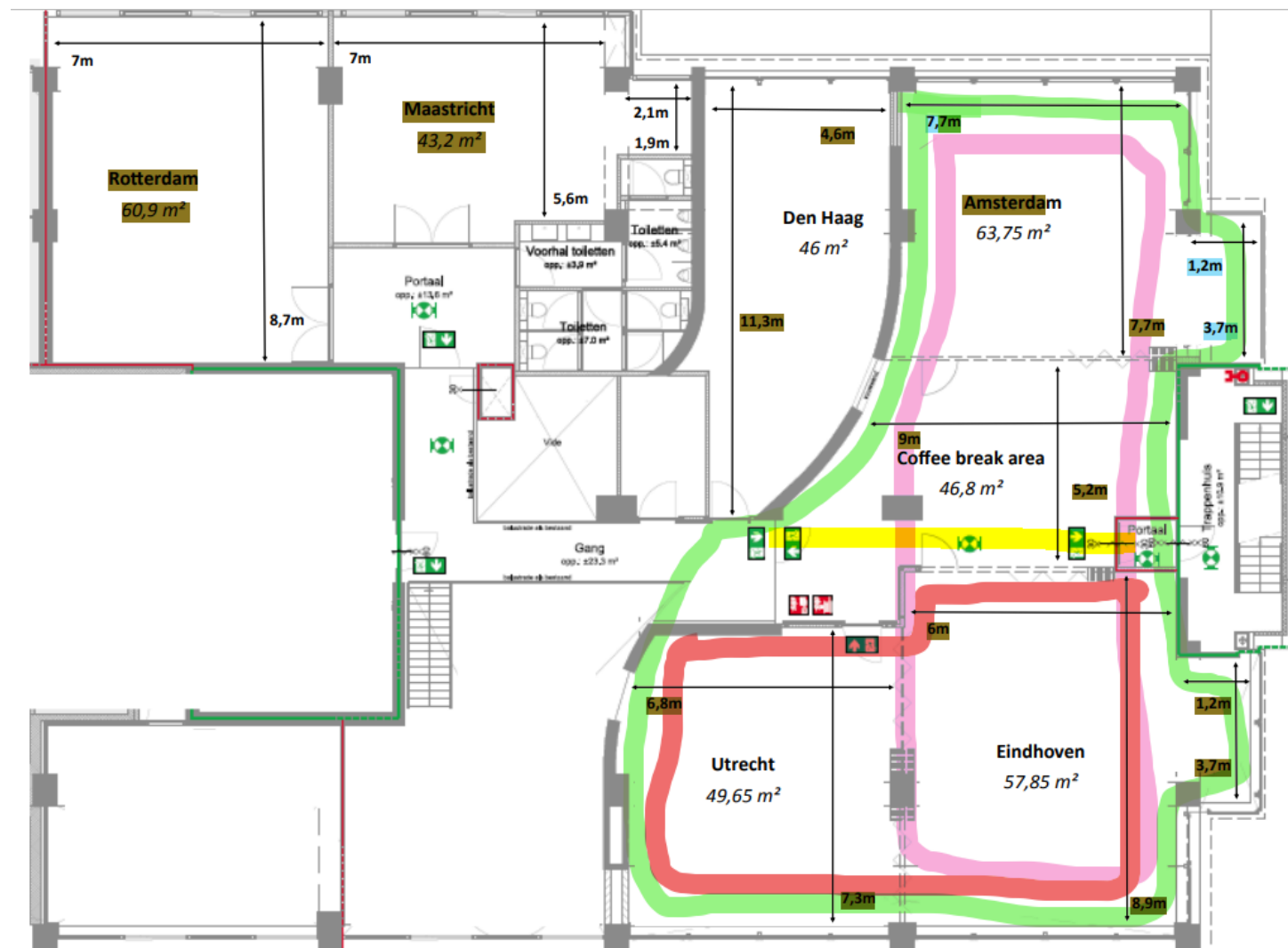

Hotel Rooms



NH COLLECTION
HOTELS

Hotel Rooms

NH Collection Eindhoven Centre has a total of 132 rooms, divided over 5 different room types:

- 54 x Superior Rooms
- 57 x Premium Rooms
- 11 x Family Rooms (sofa bed)
- 9 x Junior Suites
- 6 x Suites

The hotel has 14 floors. The hotel rooms are located on floors 2 – 7.

The look and feel in each room is the same, as well as the facilities/amenities in the rooms.

The different room types are distinguished by the number of square metres. In the next slides, you can find the specifications of each room type. Bath tubs can only be guaranteed when a suite is booked.

Superior room

54 Superior Rooms of
which:

23 Kings

9 Queens

22 Twins

Located on floors:

3, 4, 5, 6, 7

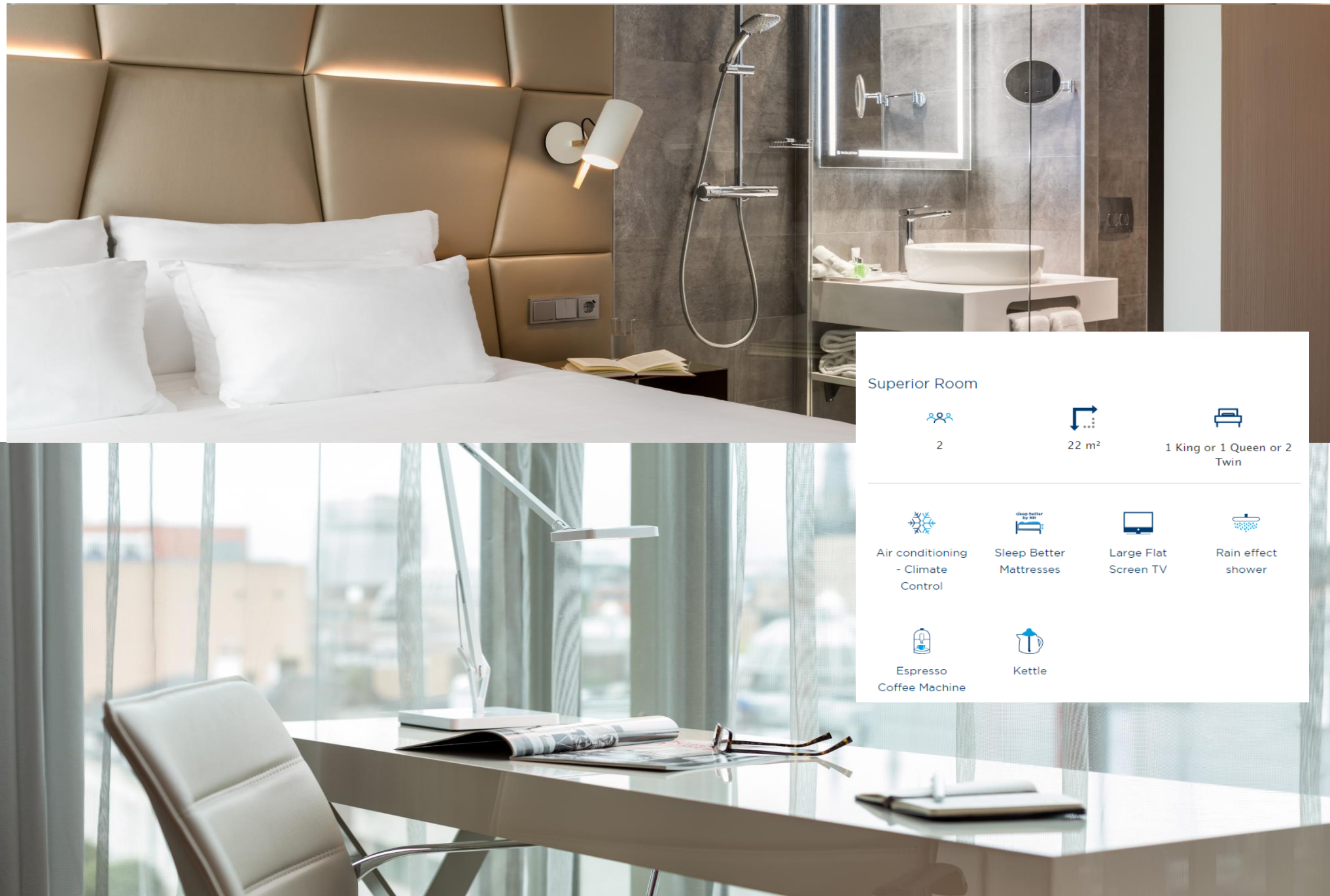

Premium Room

57 Premium Rooms of which:

25 Kings

7 Queens

25 Twins

Located on floors:

2, 3, 4, 5, 6, 7

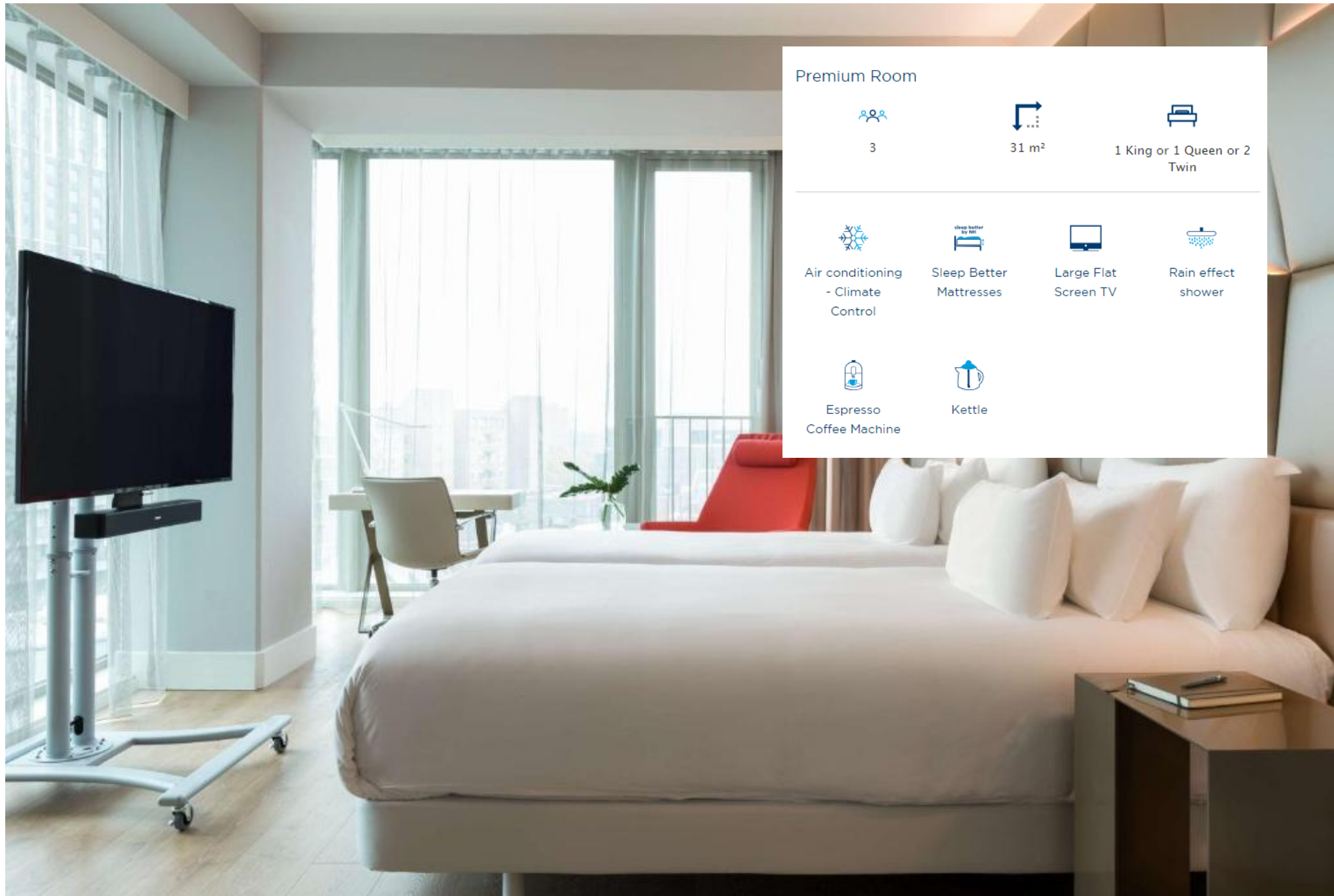

Premium Room



3



31 m²



1 King or 1 Queen or 2 Twin



Air conditioning
- Climate
Control



Sleep Better
Mattresses



Large Flat
Screen TV



Rain effect
shower



Espresso
Coffee Machine



Kettle

Family Room

11 Family Rooms of which:

11 Kings

Located on floors:

2, 3, 4, 5, 6,

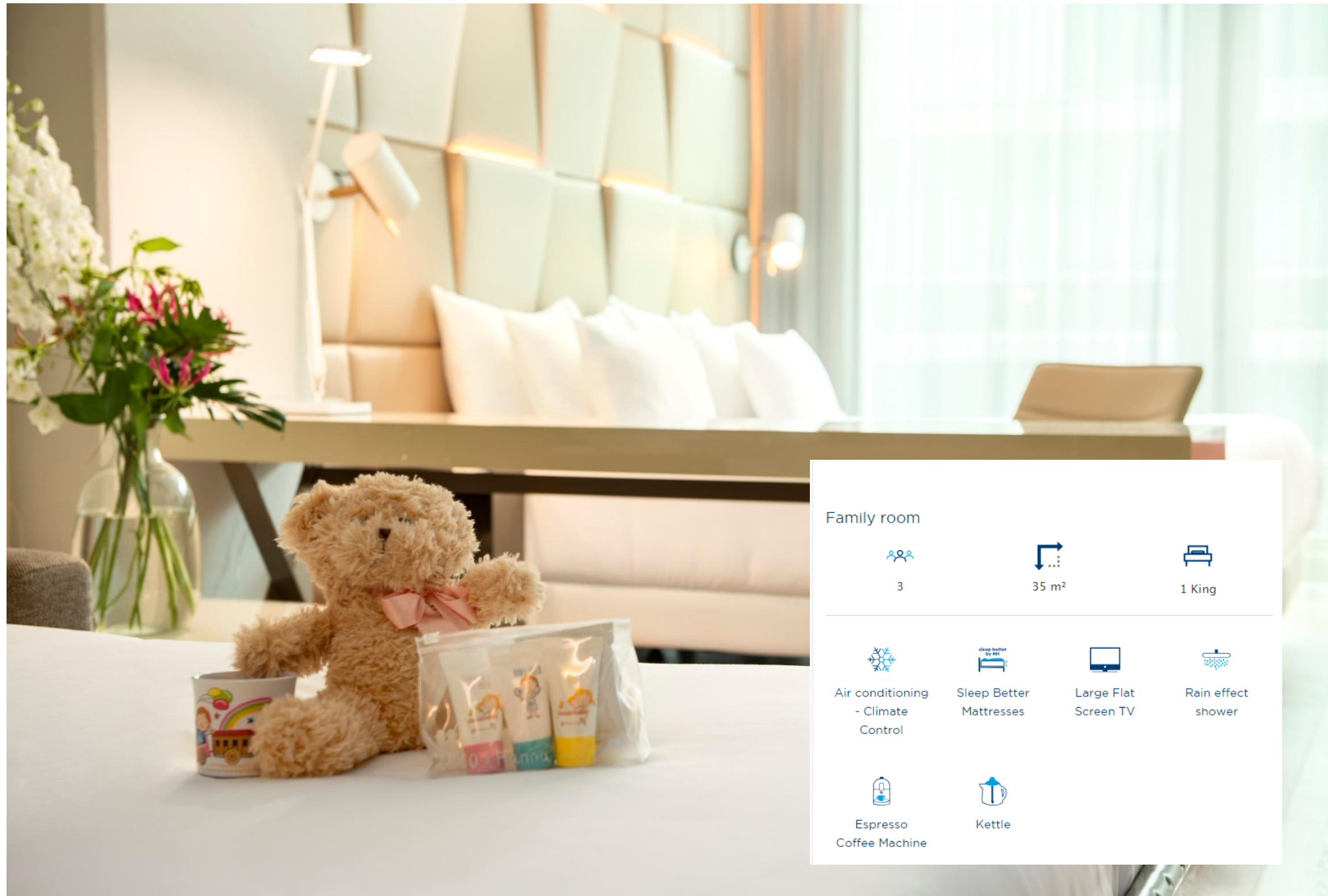

Family room



3



35 m²



1 King



Air conditioning
- Climate
Control



Sleep Better
by NH
Mattresses



Large Flat
Screen TV



Rain effect
shower



Espresso
Coffee Machine



Kettle

Junior Suite

9 Junior Suites of which:

7 Kings

2 Twins

Located on floors:

2 & 3

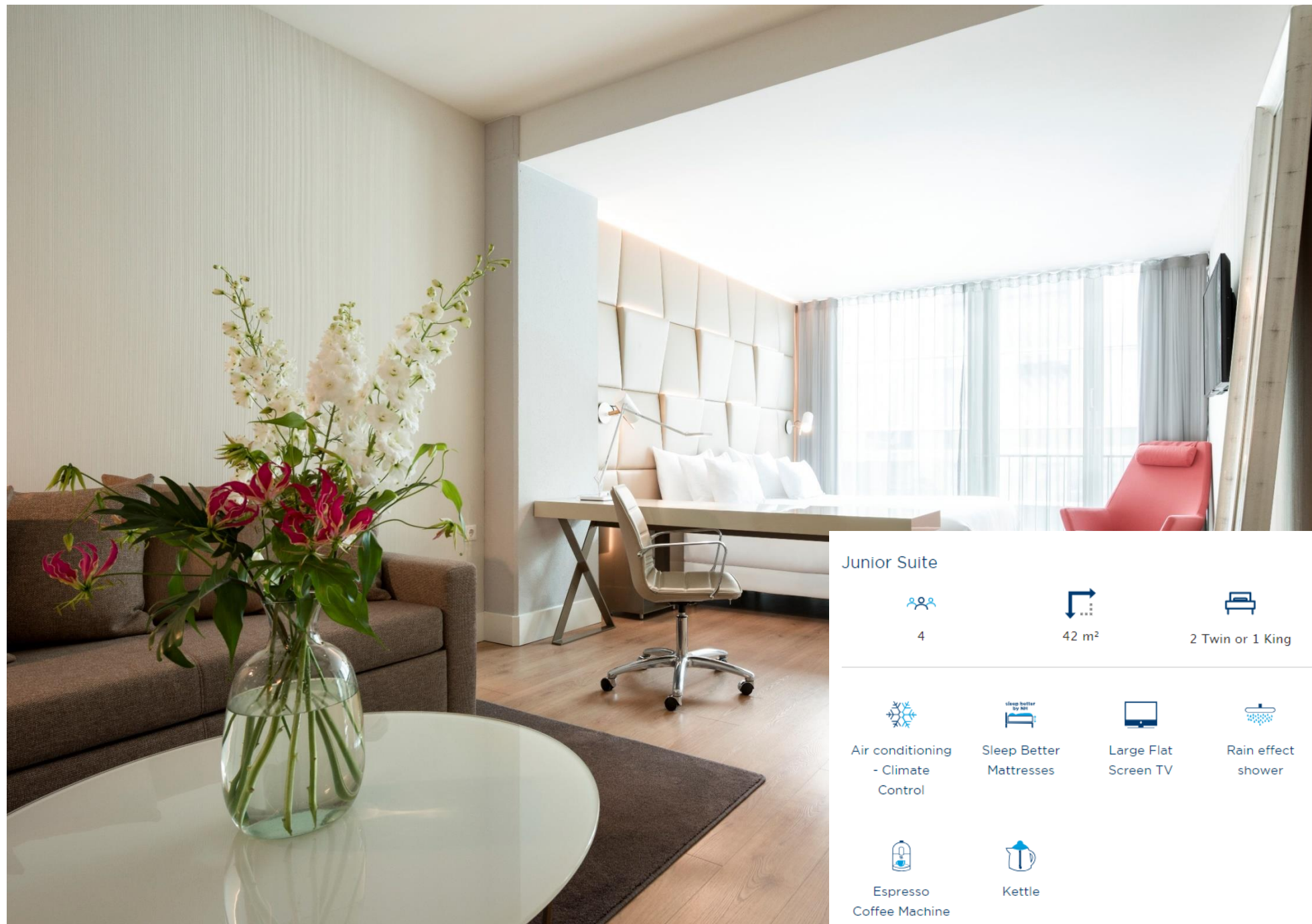

Junior Suite



4



42 m²



2 Twin or 1 King



Air conditioning
- Climate
Control



Sleep Better
Mattresses



Large Flat
Screen TV



Rain effect
shower



Espresso
Coffee Machine



Kettle

Suite

6 Suites of which:









6 Kings

Located on floors:

2 & 3



Suite

 2	 42 m ²	 1 King	
 Air conditioning - Climate Control	 Sleep Better Mattresses	 Large Flat Screen TV	 Rain effect shower
 Espresso Coffee Machine	 Kettle		

VANE Restaurant



NH COLLECTION
HOTELS

VANE Restaurant is the gastronomic highlight of Eindhoven. The culinary dishes are created by Executive Chef Carlo Chantrel and his team. Experience the place where knowledge and quality come together with fine-dining at the highest level.



Guts and experience come together

Carlo Chantrel

VANE Restaurant – Menu, Capacities and opening times

4 VANE	€ 74,00	5 VANE	€ 84,00
Wine pairing	€ 36,00	Wine pairing	€ 45,00
(only available on Wednesday and Thursday)			
6 VANE	€ 94,00	7 VANE	€ 104,00
Wine pairing	€ 54,00	Wine pairing	€ 63,00
All-in		Extra	
4 VANE all-in	€ 129,00	Cheese as extra dish	€ 18,00
(only available on Wednesday and Thursday)		Cheese instead of dessert	€ 9,00
6 VANE all-in	€ 159,00		

Opening days/times:

- Monday – Tuesday – Sunday: Closed
- Wednesday – Saturday: 18.00 – 00.00
- Summer break: 29-07.2024 – 18-08.2024

Capacities:

- Seated dinner: 80 pax
- Reception/walking dinner: 200 pax
- Semi Private dining area: 40 pax

VANE Restaurant and Skybar work with a separate reservation system called Formitable. This system is leading for them. When receiving a request for the restaurant or bar, please check with the hotel first whether it can be booked.

VANE Restaurant can be booked with exclusive use through a minimum spend of 5.500,00 EUR

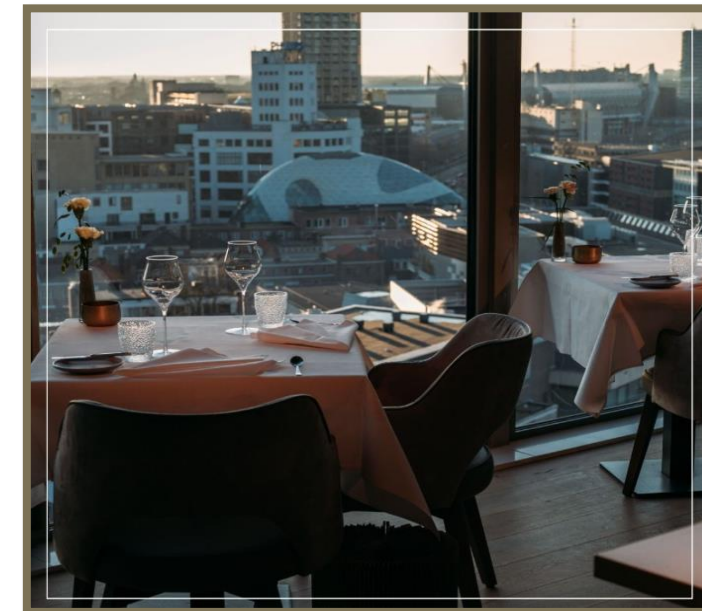

VANE Skybar



NH COLLECTION
HOTELS



A highlight in the sky of Eindhoven, from morning to evening sit down and relax at this rooftop bar with some of the best views over the city. A cocktail menu designed by the skybar team, makes for a insta-worthy moment on every visit.

“Vane is Eindhoven's hotspot.”

Team VANE Skybar





VANE Skybar – Menu, Capacities and opening times

Walking dinners

- Classic | 36,00
2 cold dishes, 1 warm mains, 1 dessert
- Superior | 48,00
2 cold dishes, 1 warm mains, 1 dessert

Bar bites

- 1pc | 5,50
- 3pc | 15,00
- 5pc | 21,00
- 7 pc | 29,95

Drink arrangements

- Classic | 17,50 p.p.p. hour
beer – wines – soft drinks
- Superior | 21,00 p.p.p. hour
classic + cava
- Extraordinary | 29.50 p.p.p. hour
superior + wodka – whiskey - gin

Opening times:

- Monday – Thursday: 17.00 – 00.00
- Friday – Sunday : 15.00 – 01.00

Capacities:

- Seated inside: 36
- Reception/walking dinner: 50 pax
- Terrace: 130 pax

VANE Restaurant and Skybar work with a separate reservation system called Formitable. This system is leading for them. When receiving a request for the restaurant or bar, please check with the hotel first whether it can be booked.

VANE Restaurant can be booked with exclusive use through a minimum spend of 5.500,00 EUR





NH COLLECTION
HOTELS